



## LED Shatterproof Glass Hybrid Type A+B CCT Adjustable Tube



**Application:** Supermarket, office, shopping mall, hotel, hospital, school, showroom, and more commercial and industrial applications

### SPECIFICATION

<b>Model NO.</b>	HYA-T8-4FT-18W-AB3CCT
<b>Power</b>	AC120-277V
<b>Input Voltage</b>	18W
<b>Luminous Flux</b>	2160lm
<b>CRI</b>	>80
<b>Power Factor</b>	>0.9
<b>CCT</b>	3500K-4000K-5000K
<b>Beam Angel</b>	207
<b>THD</b>	<20%
<b>IP Rating</b>	IP20
<b>Operating Temperature</b>	-4°F~+113°F / -20°~+45°
<b>Finish</b>	White
<b>Lifespan</b>	Maintains at least 70% light output for up to 50,000 hours
<b>DLC ID #</b>	S-LRN6BT

### GENERAL DESCRIPTION

This product offers 3 CCTs in 1 for versatile lighting effects, ensuring compatibility and cost-effectiveness. It also includes a thermal fuse and dedicated leakage protection for safety.

### FEATURE

- High Energy Efficiency: Save more than 60% energy compared to T8 fluorescent lamps. RoHS Compliant and Mercury-Free, addressing disposal concerns.
- Instant-On Light with No Flicker: Enjoy immediate illumination without any flickering.
- High Uniformity of Light: Experience consistent and evenly distributed lighting.
- Hybrid Series Type A+B for Fast and Easy Installation: Hybrid mode enables seamless installation with or without a ballast, ensuring perfect compatibility and cost-effectiveness.

### Ordering Guide

Model NO: HYA-T8-4FT-18W-AB3CCT						
Company Code	Product	Material	Length	Watt	Wiring	CCT
HYA	T8: 4FT A+BTube	Outer film glass	4 FT	18W	A+B: Hybrid with or without ballast	3500K 4000K 5000K



Project Name: _____
Date: _____ Note: _____

## LED Shatterproof Glass Hybrid Type A+B CCT Adjustable Tube

### DIMENSION



Maximum Overall Length	4FT (in)
A	47.2
B	47.5
C	47.7

### PACKAGE INFO

<b>Model. No.</b>	HYA-T8-4FT-18W-AB3CCT -35K/40K/50K
<b>Size</b>	4FT
<b>QTY/PACK</b>	25PCS
<b>Package Size</b>	1270x 180x 198mm 50"x 7.1"x 7.8"
<b>Package Weight</b>	6.3kg/13.89lbs
<b>Package CBM</b>	0.045
<b>20GP Capacity</b>	11400
<b>40GP Capacity</b>	30000
<b>40HQ Capacity</b>	36000
<b>45HQ Capacity</b>	40300

### PHOTOMETRIC REPORT

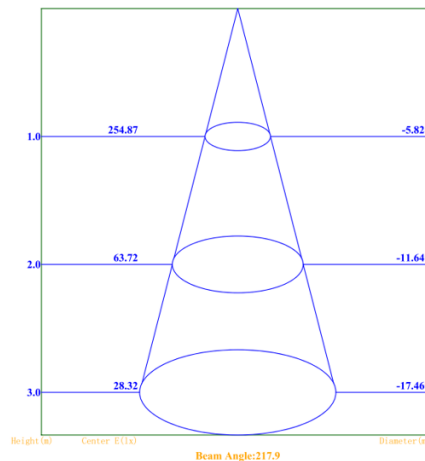
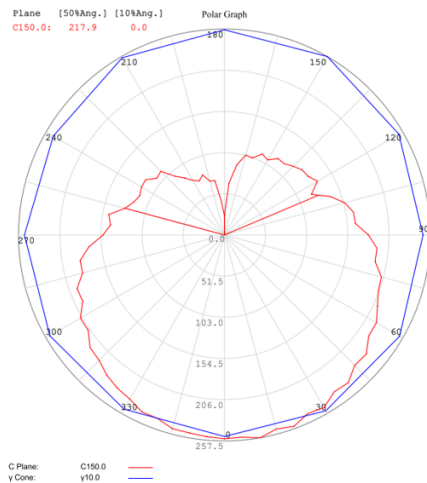



## LED Shatterproof Glass Hybrid Type A+B CCT Adjustable Tube

### INSTALLATION

#### Installation Guide



1. Turn off the power



2. Fluorescent

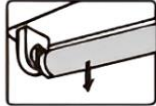

3. Fluorescent

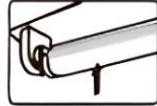

4. LED T8 instant fit



5. LED T8 instant fit



6. Turn on the power

#### Plug and Play Procedure

1. Switch off the power.
2. Remove the diffuser (if provided).
3. Take out the fluorescent tubes. Please dispose of them properly as they contain mercury.
4. Choose the appropriate CCT, then insert the LED tube into the lighting fixture.
5. Install the LED tubes and close the diffuser (if provided).
6. Turn on the power.

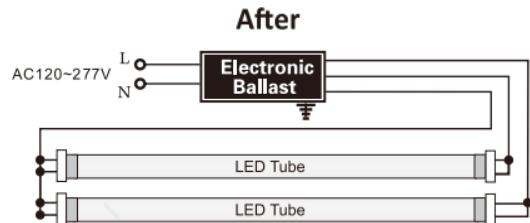
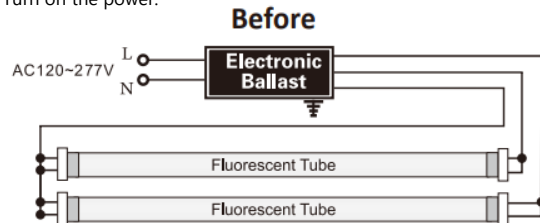

(UL Type A)

#### Retrofit Procedure

1. Switch off the power.
2. Remove the diffuser (if provided).
3. Take out the fluorescent tubes. Please dispose of them properly as they contain mercury.
4. Cut the wires according to the diagram.
5. Connect the new wires to the branch circuit as indicated.
6. Replace the cover over the wiring channel.
7. Install the LED tubes and close the diffuser.
8. Turn on the power.

#### Wire Diagrams

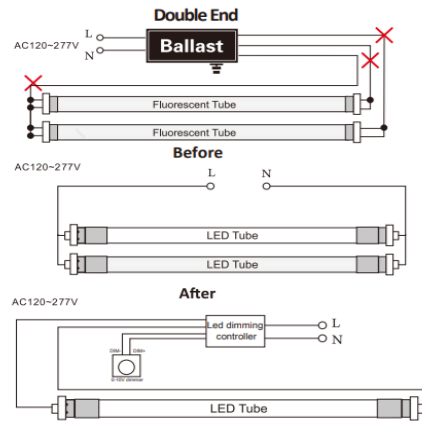
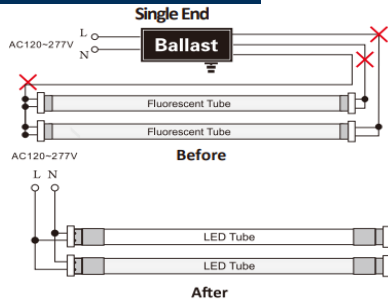

(UL TypeB)

Dimming Wire Diagrams

#### WARNING

1. These LED tubes should only be installed by a licensed electrician.
2. Use these LED tubes indoors only (in damp or dry locations). They are not suitable for wet locations.
3. Before installation, ensure that tombstones/lamp holders are in good condition and not defective.
4. Verify that the brand and model number of the ballast for the replacement tube are listed in our compatible ballast list.
5. Check that the ballast is operational and still under warranty before installation.
6. Properly position the LED tubes/613 pins into the socket during installation.
7. This device is not intended for use with emergency exits.
8. These LED tubes cannot be directly used with phase-cut dimmers or 0/1-10V dimmers. Please use a customized 1-10V dimming driver to enable dimming functionality.
9. The manufacturer is not responsible for any damage to the product or property due to improper installation. Please refer to the Installation Instructions above for guidance.

The data is based on tests conducted in controlled conditions, and actual performance may vary depending on operating conditions. Additionally, please be aware that products are subject to change or discontinuation without prior notice.



## LED Shatterproof Glass Hybrid Type A+B CCT Adjustable Tube

### Ballast List For T8 LED Tube

Our tubes are compatible with the listed ballasts. Using our LED Tube with unlisted ballasts may risk damage or losses. We're not liable for such issues if instructions aren't followed. We constantly test and update our compatibility list. If your ballast isn't listed, please contact us for help.

ACCUPRO	
1	AP-432IP-UNV
2	AP-332IP-UNV-M
ADVANCE	
1	IOPA-4P32-LW-N
ESPEN	
1	VE232MVHIPLE
2	VE232MVHIPE
3	VE432MVHIPE
4	VE432MVHIPLE
5	VE432120HIP
GE	
1	GE232MAX-L/Ultra
2	GE332MAX-N/Ultra
3	GE232MAX347-N
4	GE432MAX347-N
5	GE232-MVPS-N
6	GE332-MVPS-N
7	GE432-MVPS-N
8	GE432-120RESDIYB
9	GE-240-RS-MV-N
10	GE232-N-347
11	GE132MAX-H/ULTRA
Halco	
1	EP232IS/L/MV/HE
HOWARD INDUSTRIES	
1	EP3/32IS/MV/MC/HE
KEYSTONE	
1	KTEB-232RIS-1-TP-SL
2	KTEB-232RIS-1-TP-SL/Ga
OSRAM	
1	QHE 2x32T8/UNV ISN-SC
2	QHE 3x32T8/UNV ISN-SC
3	QHE 3x32T8/UNV PSN-SC

PHILIPS	
1	ICN-2P32-N
2	ICN-3P32-N
3	IOP-4P32-LW-N
4	IOPA-1P32-N
5	IOPA-4P32-N
6	IOPA-2P32-LW-N
7	IOP-3P32-N
SYLVANIA	
1	QHE 1x32T8/UNV ISN-SC
2	QHE 3x32T8/UNV ISL-SC
3	QTP 2x32T8/UNV ISL-SC
4	QTP 2x32T8/UNV ISN-SC
5	QT 4X32/120 LP
6	QT 2x32 T8/347 ISL-SC
7	QHE 4x32T8/347 ISN-SC
8	QHE 4x32T8/347 ISL-SC
TRIAD	
1	B232IUNVHP-N
2	B332IUNVHP-A
3	B432IUNVHP-A
4	B232IUNVHP-B
UNIVERSAL	
1	B332IUNVHE-A
2	B432IUNVHE-A
3	B232IUNVEL-N
4	B332IUNVEL-A
5	B232IUNVHEH-A
6	B332PUNVHE-A
7	B4321UNVEL-A
WORK HORSE	
1	WH3-120-C
2	WH3-120-L
Pacific Fluorescent	
1	EB-232IS-120-RES

The data is based on tests conducted in controlled conditions, and actual performance may vary depending on operating conditions. Additionally, please be aware that products are subject to change or discontinuation without prior notice.